

ZEHUS

BIKE+

all in one

GETTING STARTED MANUAL

start here
inizia da qui
beginne hier
commencez ici

1

- download the bitride app

- scarica l'app bitride

- lade die bitride app herunter

- téléchargez l'app bitride

bitride

iPhone



<https://goo.gl/ryvMuY>

Android™



<https://goo.gl/yo1axU>

2

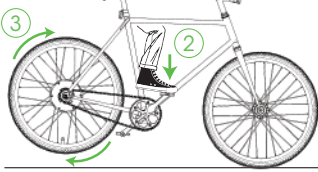

- spin the rear wheel to turn on BIKE+ all in one

- fai girare la ruota posteriore per accendere BIKE+ all in one

- drehe das Hinterrad um BIKE+ all in one einzuschalten

- tournez la roue arrière pour démarrer BIKE+ all in one

3

- connect BIKE+ all in one

- connetti BIKE+ all in one

- verbinde das BIKE+ all in one

- connectez BIKE+ all in one

iPhone

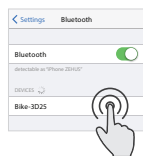
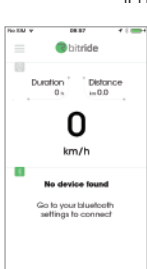

- select a device
- seleziona un device
- wähle ein Gerät aus
- sélectionne un dispositif



Android™



4

- register BIKE+ all in one

- registra BIKE+ all in one

- registriere dein BIKE+ all in one

- enregistrez BIKE+ all in one



internet connection

- internet connection needed
- necessaria connessione internet
- Internetverbindung erforderlich
- connexion Internet nécessaire

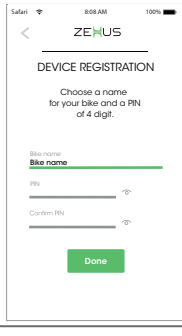

5

- calibrate the slope sensor

- calibra il sensore di pendenza

- kalibriere den Neigungssensor

- calibrez le capteur de pente



0 km/h!

0°!

iPhone

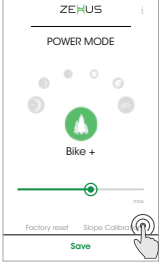

Android™

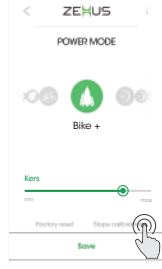

6

- choose your power mode

- scegli la tua modalità di assistenza

- wähle eine Unterstützungsstufe aus

- choisissez votre niveau d'assistance électrique

- tip: try the turbo mode first!

- per iniziare, prova la modalità turbo!

- versuche mit dem Turbo-Modus zu beginnen

- pour commencer, essayez la modalité turbo

iPhone

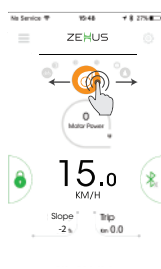

Android™

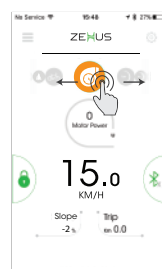

7

activate BIKE+ all in one:

1 - push the bike up to 8 km/h

2 - push-pedal per 3 revolutions

attiva BIKE+ all in one:

1 - arriva fino a 8 km/h

2 - pedala all'indietro per 3 giri

Aktivieren des BIKE+ all in one:

1 - Anschubhilfe bis zu 8km/h

2 - drei mal nach hinten treten

pour activer BIKE+ all in one:

1 - pédalez jusqu'à 8 km/h

2 - retropedaléz 3 fois

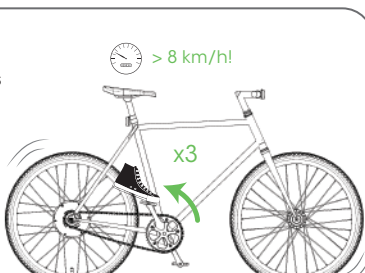

8

- charging BIKE+ all in one

- caricare BIKE+ all in one

- lade das BIKE+ all in one auf

- chargez BIKE+ all in one

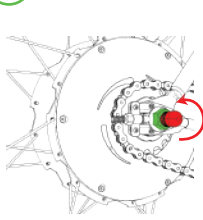

1

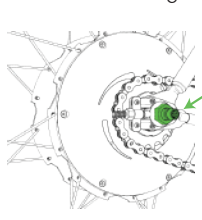

2

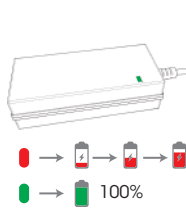

3

100%

9

- lean the bike to turn it off

- inclina la bici per spegnerla

- neige das Rad um es einzuschalten

- penchez le vélo pour l'arrêter



OR



IMPORTANT SAFETY NOTES! NOTE DI SICUREZZA IMPORTANTI!

SICHERHEITSHINWEISE! NOTE DE SÉCURITÉ

- Always use the bike with the protective close nuts
- Always turn off BIKE+ all in one during maintenance, servicing and handling
- Protect BIKE+ all in one from severe heat, fire and high pressure water-jets
- DO NOT open the unit yourself
- Charge the battery in a dry and clean environment

- Utilizzare SEMPRE la bici con i dadi chiusi di protezione
- Spegner SEMPRE BIKE+ all in one durante tutte le operazioni di manutenzione
- Proteggere BIKE+ all in one da temperature elevate, fuoco e getti di acqua ad alta pressione
- NON aprire l'unità
- Utilizzare il caricabatterie solo in un ambiente asciutto e pulito

- Rad nur mit festgezogenen Sicherungsmuttern benutzen
- Schalte BIKE+ während der Wartung und Pflege immer aus
- Schütze BIKE+ all in one vor Hitze, Wärme und Wasser

- Ein selbstständiges Verfall des BIKE+ all in one Systems, führt zum sofortigen Verfall der Garantie
- Batterie in einer trockenen, sauberen Umgebung aufbewahren und laden
- Utilisez toujours le vélo avec les écrous de protection
- Éteignez BIKE+ all in one pendant toutes les opérations de manutention
- Protégez BIKE+ all in one contre la chaleur, le feu et les jets d'eau à haute pression
- N'ouvrez PAS l'appareil
- Utilisez le chargeur uniquement dans un environnement sec et propre

Made for iPhone, means that an electronic accessory has been specifically designed to connect specifically to iPod, iPhone, or iPad, respectively, and has been certified by the developer to meet Apple performance standards. Apple is not responsible for the operation of this device or its compliance with safety and regulatory standards. Please note that the use of this accessory with iPod, iPhone, or iPad may affect wireless performance rights or other intellectual property rights.

This document is subject to change without notice.

